

MVP ICON® Temperature Probe Cat. No. 78087-00

General Description

The MVP ICON® Temperature Probe is a thermistor housed in a stainless steel probe designed for general purpose temperature measurement of liquids or semi-solids ranging from -55 to 125 °C. It is designed for use with the MVP ICON® instrument only. Any other combination might cause loss of performance or irreversible damage to both probe and instrument.

Kit Components

Each kit contains one MVP ICON® Temperature Probe.

Connecting/Disconnecting Probe



1. To connect:

- a. Make sure side with screws and label is facing up (**STEP 1**).
- b. Plug connector into probe port (**STEP 2**).

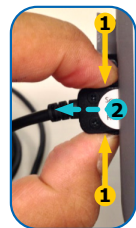

2. To disconnect:

- a. Pinch side tabs in (**STEP 1**).
 - b. Pull connector straight out (**STEP 2**).
- Do **NOT** use force as this may result in damage to the connector and/or instrument port resulting in required repair.

Test Procedure

1. Using the MVP ICON® Temperature Probe

- a. Configure MVP ICON® instrument to **< TEMPERATURE >** at the top of the screen.
- b. Select test point and follow instructions on the MVP ICON® screen to complete the reading. Results will display in either °C or °F based on instrument settings.
- c. When measuring semi-solids, insert probe to desired depth, rotate left to right several times, and tilt to ensure sample contact.
- d. If the sample temperature is fluctuating, the probe will need to stabilize before a reading is given.

2. Calibration

The MVP ICON® Temperature Probe features a single-point calibration that can be done at any known temperature within the operating range.

Note: Calibration should be performed prior to first initial use. The calibration is most accurate when using a known, stable temperature close to the sample temperature range.

- a. With MVP ICON® in **< TEMPERATURE >** mode, press **Device >> Calibration**.
- b. Insert probe into a liquid of known stable temperature, enter value into the **Reference Value** field (in listed unit, °C or °F), then press **Calibrate**.
- c. The date of last calibration will appear on the MVP ICON® Home screen.

Storage

Clean probe thoroughly with water and a mild detergent solution. Rinse with deionized water. Store probe in original packaging when not in use.

Precautions

- The MVP ICON® Temperature Probe is rugged and durable and requires little maintenance. To ensure lasting performance read and follow all operating guidelines.
- Avoid prolonged exposure within samples at either end of the specified temperature range. Do not use the probe outside the specified temperature range (see **Specifications**) as this might result in probe failure or irreversible damage.
- Samples must be liquids or semi-solids.

Specifications

Sensor:	Thermistor
Temperature range	-55 to 125 °C
Resolution	0.1 °C
Accuracy	±0.5 °C

To place an order or receive technical assistance please visit: SigmaAldrich.com